



Argyle Road, London, E1





**Price Guide £450,000 -  
£475,000**

**A charming ground  
floor one-bedroom  
Victorian garden  
conversion overlooking  
Carlton Square.**



## Leasehold

- Victorian Conversion
- Double Bedroom
- Separate Kitchen
- Stepney Green Tube Station Close By
- Private Rear Garden
- Peaceful Location
- Stylish Bathroom
- Views Of Carlton Square Gardens

This characterful home offers well-proportioned room sizes throughout, blending classic charm with comfortable modern living. Large windows provide attractive green views and allow an abundance of natural light to fill the living space.

The accommodation includes a generous reception room, a double bedroom, a well-appointed separate kitchen, and a bathroom finished in a timeless style. The property also benefits from access to a private garden, offering a peaceful outdoor retreat ideal for entertaining.

Perfectly positioned within a sought-after conservation area, the apartment enjoys a village-like setting while remaining close to local amenities, cafés, and excellent transport links, making it an ideal home for professionals.









Argyle Road, E1

Approx Gross Internal Area : 43.2 sq m / 465 sq ft

BUTLER & STAG

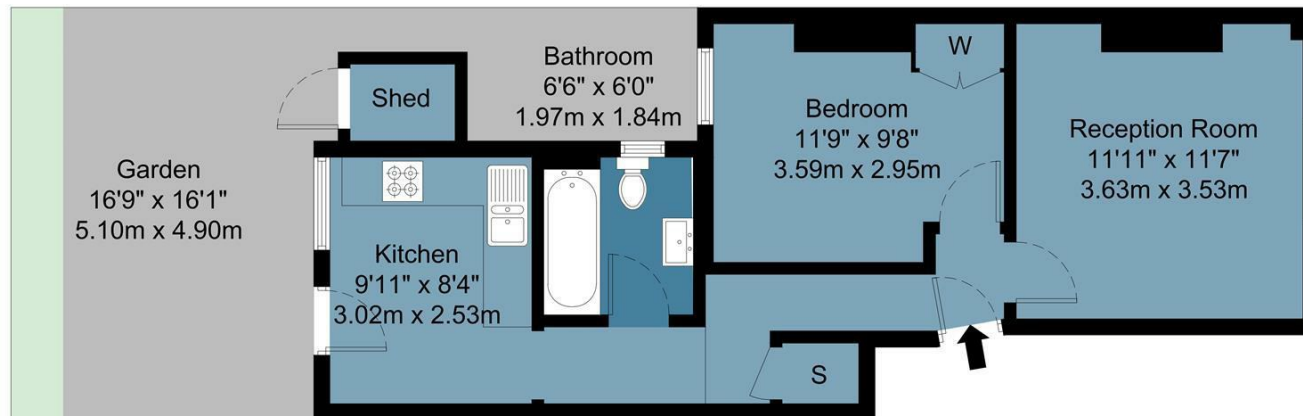

Ground Floor

Measurements are approximate and for illustration purposes only. While we do not doubt the accuracy and completeness, we advise you conduct a careful independent assessment of the property to determine monetary value.  
© @ Maison VUE | [www.maisonvue.com](http://www.maisonvue.com)

IMPORTANT NOTICE - These particulars have been prepared in good faith and they are not intended to constitute part of an offer or contract. We have not performed a structural survey on this property and the services, appliances and specific fittings have not been tested. All photographs, measurements, floor plans and distances referred to are given as a guide and should not be relied upon.

BUTLER & STAG

☎ 020 8102 1236

🏠 508 Roman Road, Bow, London, E3 5LU

✉ [bow@butlerandstag.com](mailto:bow@butlerandstag.com)

[www.butlerandstag.uk](http://www.butlerandstag.uk)